

# Lactose Intolerance quick test



RAPID RESULTS DURING GASTROSCOPY



## Confirmed results during gastroscopy

The Lactose Intolerance quick test detects all types of lactase deficiency from biopsy specimens. This gives added value to gastroscopies with minimum effort. The test is based on the normal lactase enzyme reaction and is therefore able to detect lactase deficiency as well as indicate the functionality of the enzyme. The lactose intolerance quick test is not only a sensitive diagnostic tool, but it has also been found to be more accurate than than hydrogen breath tests for lactose intolerance in predicting clinical response to lactose-free diet.

## Easy testing from a duodenal biopsy specimen

The test procedure of the Lactose Intolerance quick test is fast and simple. The biopsy specimen is placed in the test plate and test reagents are added to the sample. A clear color change indicates the test result within 20 minutes enabling testing and reporting in endoscopy.

- Results in 20 minutes
- Simple color chart interpretation
- All reagents ready-to-use
- Sensitivity 95 %, specificity 100 %<sup>2</sup>
- Superior sensitivity compared to hydrogen breath test<sup>3</sup>

## Product specifications

Sample: duodenal biopsy specimen

Test principle: detection of lactase activity

Kit components:

- test plate
- reagent bottles (3 pcs)
- instruction for use

Storage: 2-8 °C

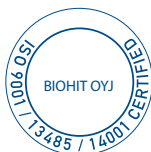

Not available in the United States. In Japan for research use only. Check availability for other markets.

## Reference

1. Jolanda F, Parodi F et al. Poster presentation at DDW 2009; S2067.
2. Kuokkanen M, Myllyniemi M et al. Endoscopy 2006; 38: 708-712.
3. Ojetti V, La Mura R et al. Dig Dis Sci. 2008; 53(6): 1589-92

## Ordering details:

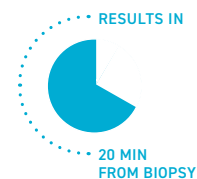

REF	Product
602010	Lactose Intolerance quick test, 25 tests
602012	Lactose Intolerance quick test, 10 tests
602018	BIOHIT Lactase Control

## Simple test procedure

1. Place biopsy into the well.  
Add two drops of **reagent 1**.

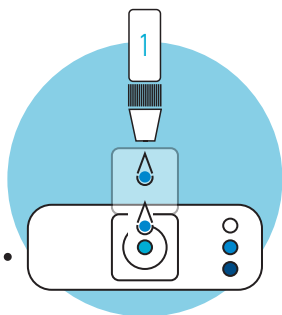

2. Add one drop of **reagent 2**, and two drops of **reagent 3**.  
Shake the plate.

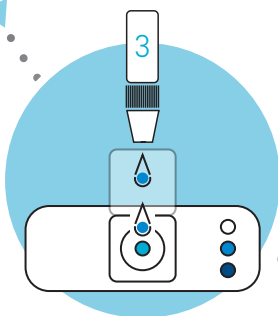
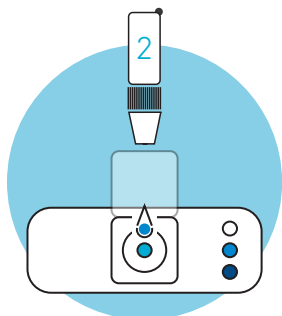

The test procedure of the Lactose Intolerance quick test is fast and simple.

3. Read the result against the color chart.

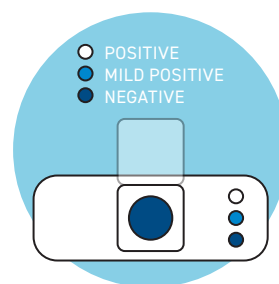

Results in 20 minutes

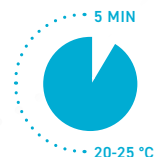

### CONTACT

**Biohit Oyj** Laippatie 1,  
00880 Helsinki, Finland  
Tel. +358 9 773 861  
info@biohit.fi

**Biohit HealthCare Srl.** Via Figino 20/22,  
20016 Pero (Milano), Italy  
Tel +39 02 381951, Fax +39 02 38236521,  
info.italy@biohit.fi

**Biohit HealthCare Ltd.** Pioneer House,  
North Rd, Ellesmere Port, CH65 1AD,  
United Kingdom  
Tel. +44 151 550 4 550, Fax. +44 151 550 4 551  
info@biohithealthcare.co.uk